

TYPE	DESCRIPTION	LAMP	LUMENS	BUG RATING	MOUNTING	QTY.
A	AMERLUX CPL-P-3M-3K-T3-VOLTS-FINISH-ILA- MWS-DIM w/APRTS-18'-FINISH-5-COV (MOUNTED AT 20' AFF)	LED	6,524	2-0-2	(MOUNTED AT 20' AFF)	90

1 **FIXTURE TYPE A**
SCALE: NTS

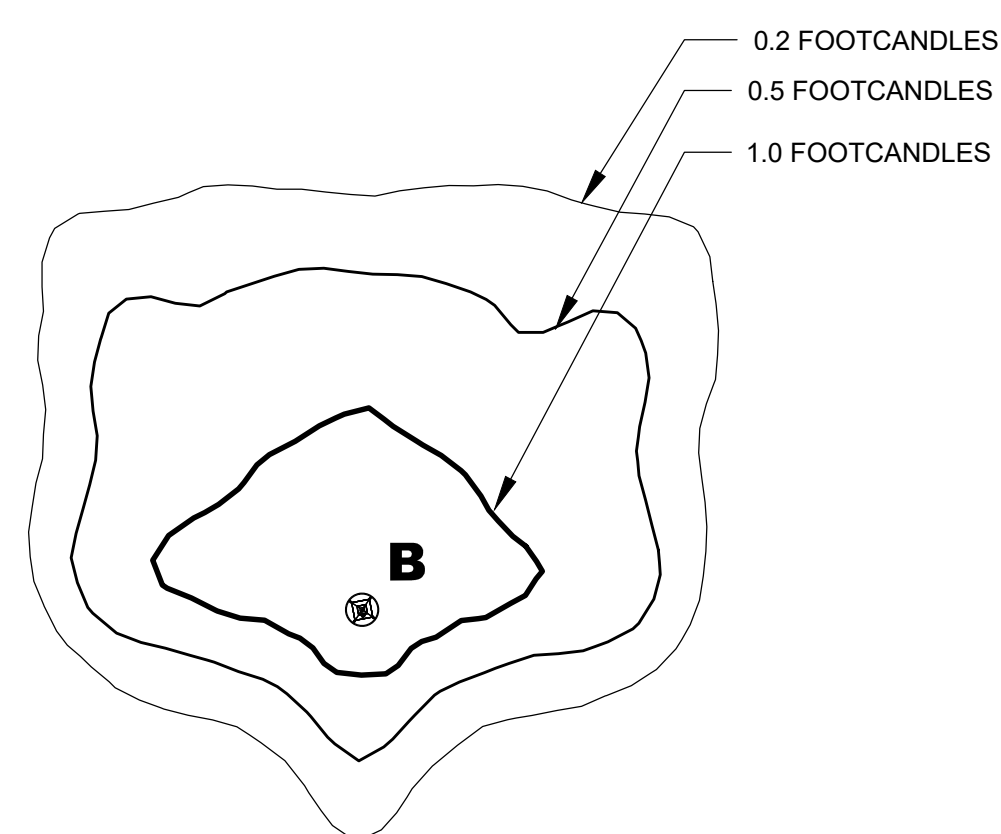

TYPE	DESCRIPTION	LAMP	LUMENS	BUG RATING	MOUNTING	QTY.
B	AMERLUX CSL-P-3M-3K-T4-VOLTS-FINISH-ILA- MWS-DIM w/APRTS-18'-FINISH-5-COV (MOUNTED AT 20' AFF)	LED	6,318	1-0-2	(MOUNTED AT 20' AFF)	25

4 **FIXTURE TYPE B**
SCALE: NTS

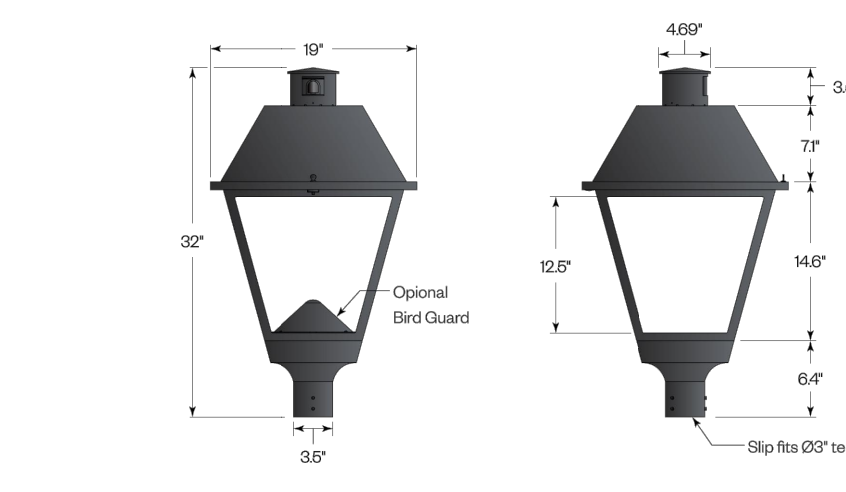

TYPE	DESCRIPTION	LAMP	LUMENS	BUG RATING	MOUNTING	QTY.
C	AMERLUX CSL-P-4M-3K-T5-VOLTS-FINISH-ILA- MWS-DIM w/APRT5-18"-FINISH-5-COV (MOUNTED AT 20' AFF)	LED	8,350	3-0-1	(MOUNTED AT 20' AFF)	17

5 **FIXTURE TYPE C**
SCALE: NTS

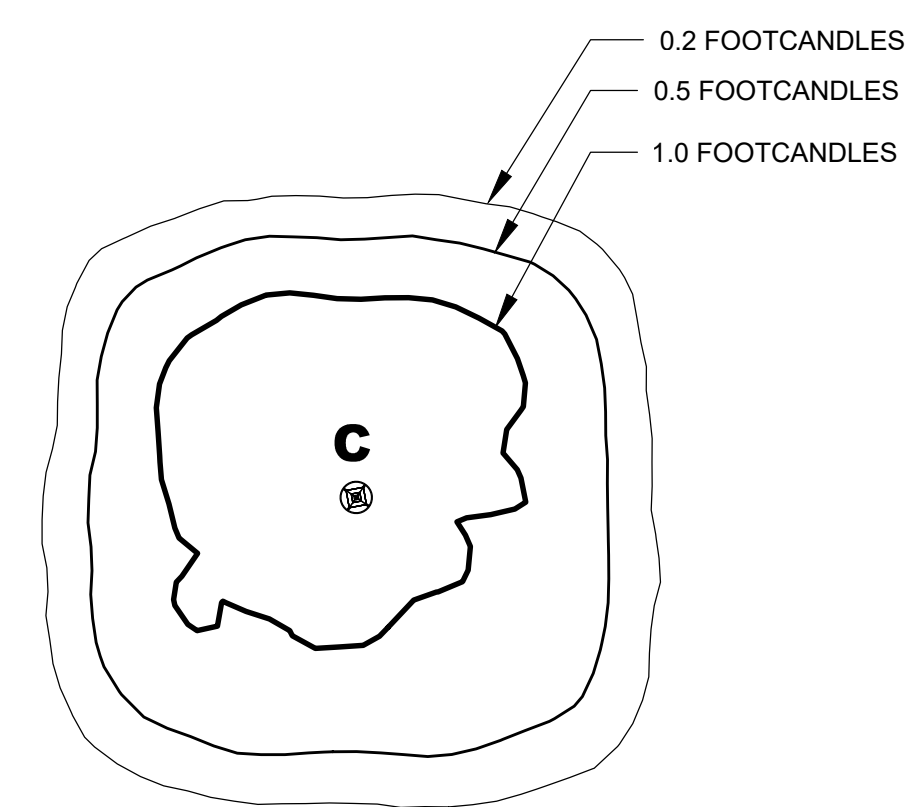

LOCATE FUSEHOLDER AND FUSE DIRECTLY INSIDE HAND HOLE SEPARATELY FOR EACH LUMINAIRE BALLAST

CONDUIT STUBS TO BE INSTALLED TO HEIGHT OF ANCHOR BOLTS

POLE BASE WITH LEVELING NUTS & 1" GROUT (MIN.)

#8 BARE GROUND WIRE

POLE GROUND LUG WITH FEMALE $\frac{3}{8}$ " X 13 NC THREAD

1" CHAMFER

CLAMP SUITABLE FOR DIRECT BURIAL

#8 BARE GROUND WIRE

$\frac{3}{4}$ " X 10'-0" COPPER CLAD GROUNDING ROD

POLE SHAFT

POLE BASE WITH 1" GROUT

GALVANIZED ANCHOR BOLTS & HARDWARE PER MANUFACTURER

ROUND CONCRETE BASE

ELECTRICAL CONDUIT

VERTICAL REINFORCEMENT WITHIN #4 @ 12" O.C. TIES

MAINTAIN 3" MINIMUM CONCRETE COVERAGE ON ALL BARS

FOOTING DIAMETER

FOOTING DEPTH

PLAN

SECTION

FOOTING DIAMETER

MOUNTING HEIGHT	FOOTING DEPTH	FOOTING DIAMETER	VERTICAL REINFORCEMENT	'H'
20'	4'-6"	2'-0"	6 #6 BARS	0'-0"

NOTES:

1. SHAFT CAP, ARMS, BASE FLANGE, ANCHOR BOLTS, LEVELING NUTS, CONNECTION HARDWARE, BOLT COVERS, HANDHOLE COVER, AND BOLT CIRCLE TEMPLATE SHALL BE FURNISHED BY POLE MANUFACTURER.
2. EACH STANDARD TO BE PROTECTED AGAINST LIGHTNING WITH AN INTERCONNECTED GROUND ROD. THIS ROD SHALL BE BONDED PER SECTION NUMBER 250-86, N.E.C.
3. ALL CONDUCTOR AND GROUNDING BASKETS ARE POURED / PLACED ABSOLUTELY VERTICAL & LEVEL.
4. POLE BASE SHALL BE ONE CONTINUOUS POUR. EXPOSED PORTION OF BASE SHALL BE HAND-RUBBED SMOOTH.
5. CONTRACTOR TO COMPACT SUBGRADE AROUND POLE BASE PER EARTHWORK SPECIFICATIONS / GEOTECH REPORT.
6. THE INFORMATION ILLUSTRATED IN THE LIGHT POLE FOUNDATION DETAIL HAS BEEN PROVIDED FOR GENERAL REFERENCE AND PRELIMINARY COST ESTIMATE PURPOSES.

3 LIGHT POLE BASE

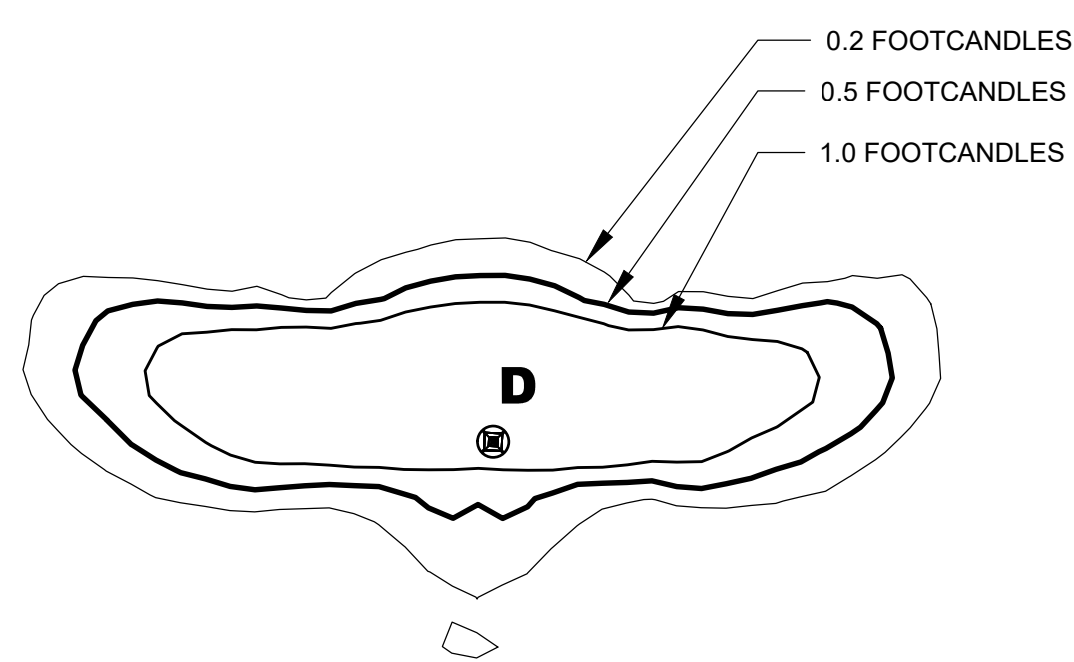

TYPE	DESCRIPTION	LAMP	LUMENS	BUG RATING	MOUNTING	QTY.
C	AMERLUX CSL-P-4M-3K-T2-VOLTS-FINISH-ILA- MWS-DIM w/APRT5-18'-FINISH-5-COV (MOUNTED AT 20' AFF)	LED	8,503	2-0-2	(MOUNTED AT 20' AFF)	17

6 **FIXTURE TYPE D**
SCALE: NTS

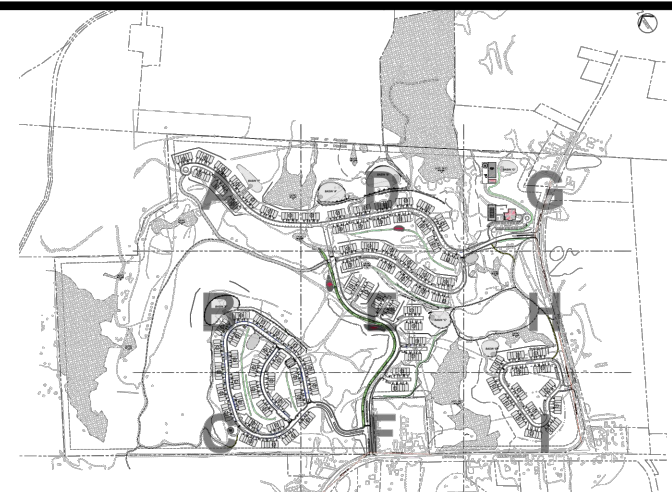

CONSULTANTS

PS&S
integrating design & engineering

67A MOUNTAIN BOULEVARD EXTENSION
P.O. BOX 4039
WARREN, NEW JERSEY 07059
PHONE: (732) 560-9700
FAX: (732) 560-9768

LISA A. DIGEROLAMO, P.E.
PROFESSIONAL ENGINEER
NEW YORK LIC. NO. 086749

SIGNATURE _____ DATE _____

[illegible]

PROJECT TITLE

PRELIMINARY & FINAL SITE PLAN

Gan-Eden Estates

TOWN OF THOMPSON SULLIVAN COUNTY NEW YORK

TAX LOT
SECTION 2,
BLOCK 1/ LOT 6.3

LANDSCAPE AND LIGHTING DETAILS

INITIAL DATE OCT. 15, 2019	JOB NO. 01895.0053
SCALE NOT TO SCALE	B/O
DRAWN C.Y. / F.M.	SHEET NO. C-20 82 OF 103
CHKD. L.A.D.	